



FL820-3 OB 1800W

TECHNICAL DATASHEET

FL820 LED Floodlighting System with Integral driver provides an innovative solution for area lighting. The FL820 is a high output LED floodlight, which is designed for all types of area lighting, and may be used as a replacement for existing 2kW floodlight systems. This triple module FL820 has CSP (Chip Scale Package) LEDs.



FL820-3 FCO



FL820-3 L24



FL820-3 Projector

SPECIFICATION

Light Source	CSP chip scale package LED		
Number of LEDs	256 LEDs per module (2 x 128) 768 LEDs total		
Correlated Colour Temperature	3000K, 4000K, 5700K		
Colour Rendering Index	>70		
Optical Cover	Flat glass		
Electrical Class	I		
Lumen Maintenance output	L90 @ 80,000 hours, Ta = 45°C L92 @ 100,000 hours, Ta = 25°C		
Driver Current	500mA - 1600mA		
Operating Temperature	-40°C to +50°C*		
Storage Temperature	-40°C to +85°C		
Installation Height	10 - 60m		
Material	Marine Grade Aluminium (LM6) Module, Aluminium cowl, Galvanised steel stirrup		
Finish	Aluminium parts polyester powder coated RAL 9010		
Ingress Protection	IP66		
Luminaire Tilt (on site)	-15° to +15°		
Product Configuration	FL820-3-FCO	FL820-3-L24	FL820-3-Projector
Max. Luminaire Luminous Flux	232,260lm	237,930lm	258,360lm
Power Consumption	543-1758W	543-1758W	543-1758W
Wind Area Side (FPA)	0.27m ²	0.20m ²	0.17m ²
Wind Area Front (FPA)	0.24m ²	0.28m ²	0.39m ²
Weight	43.9kg	39.7kg	37.2kg
Efficiency at full power (4000K)	132lm/W	135lm/W	147lm/W
Maximum efficiency (4000K)	160lm/W	164lm/W	178lm/W
Approvals	IEC 60598-2-5 CE and UKCA		

* The available output power of this luminaire is temperature dependent. Contact us for detailed performance specifications.

Input details			FL820-3 per MCB					
Input AC Voltage	Frequency range	Inrush current	B10	B16	B25	C10	C16	C25
220V	50 - 60Hz	5.40A for 8.6mS	0	1	1	0	1	2
277V	50 - 60Hz	8.40A for 8.6mS	0	1	2	1	1	2
400V	50 - 60Hz	11.8A for 9.2mS	0	1	1	0	1	2
480V	50 - 60Hz	15.5A for 8.8mS	0	1	2	1	1	2

VARIANTS

FL820-3-F
(TRIPLE MODULE FULL CUT OFF)

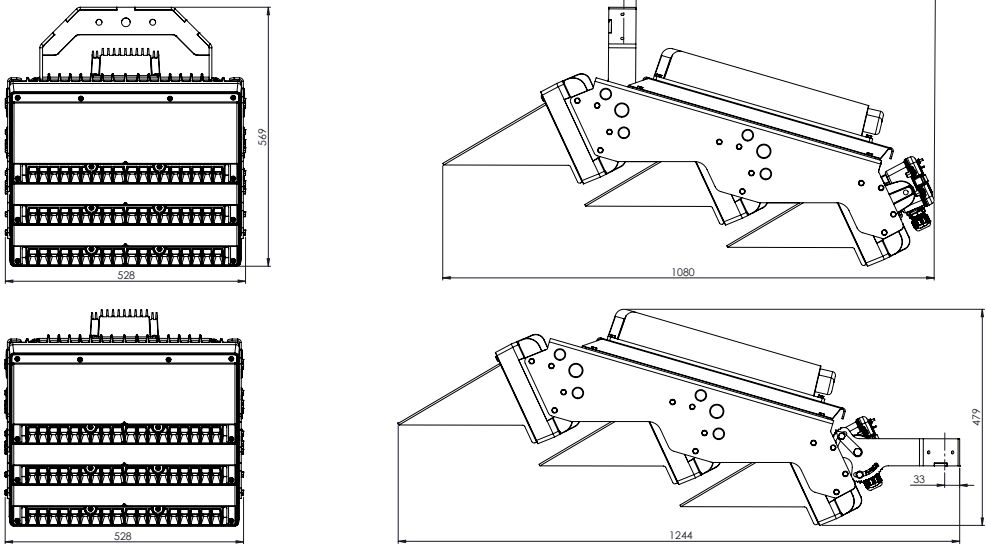

FL820-3-L24
(TRIPLE MODULE - L24 30° COWL)

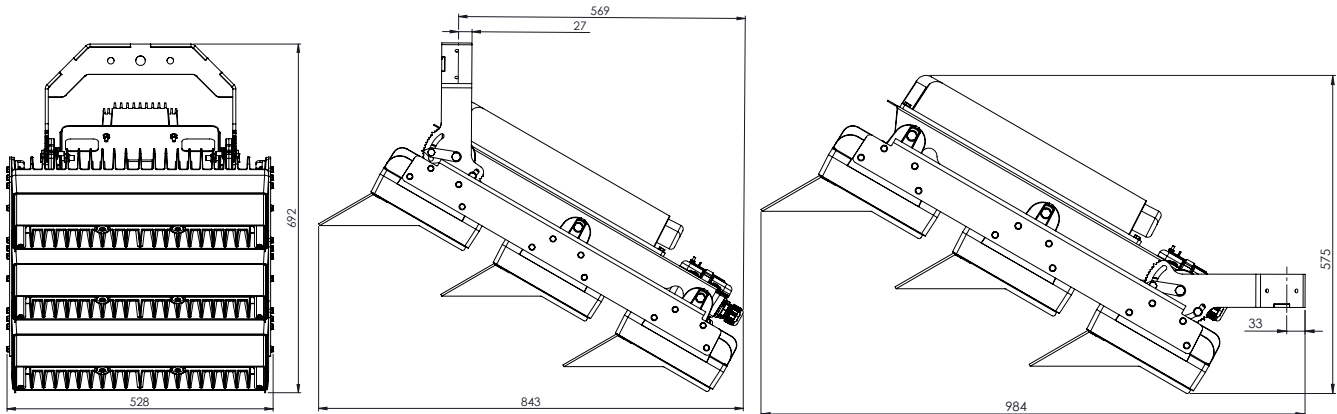

FL820-3-P
(TRIPLE MODULE PROJECTOR)

